

ROSSVALE CHURCH

THIS BUILDING IS OVER 100 YEARS OLD, WITH WEATHERBOARD EXTERIOR AND V.J. INTERIOR.
IT ALSO HAS HARDWOOD TOUNGE AND GROOVE FLOORING.

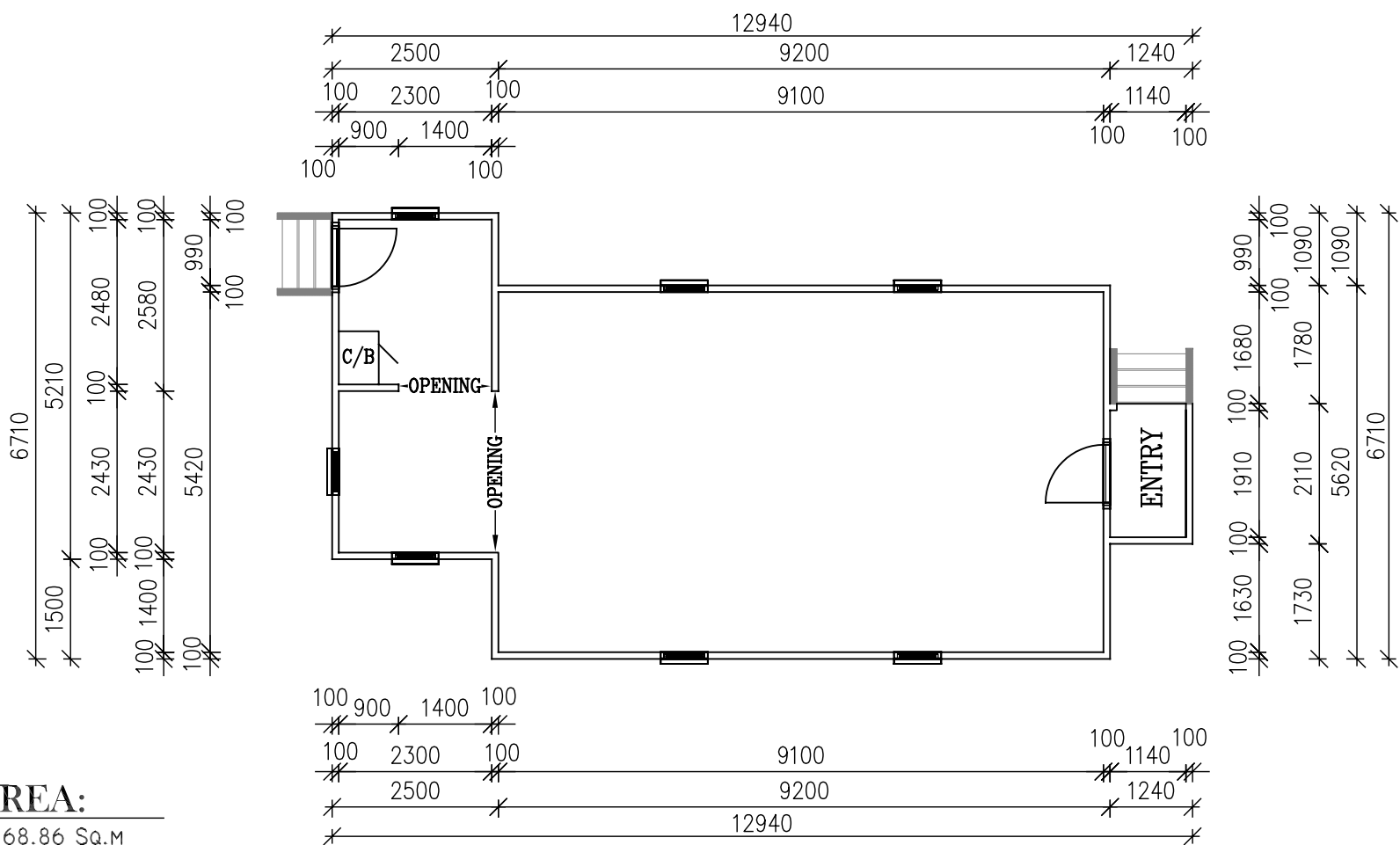

FLOOR AREA:

LIVING AREA = 68.86 Sq.M
ENTRY AREA = 2.83 Sq.M

TOTAL AREA = 71.69 Sq.M

FLOOR AREA:

LIVING AREA = 7.41 Sq's
ENTRY AREA = 0.3 Sq's

TOTAL AREA = 7.71 Sq's

FLOOR PLAN

SCALE 1:100

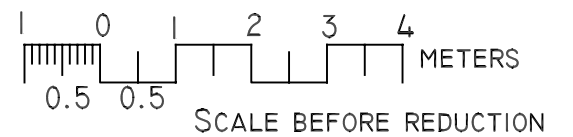

ROSSVALE CHURCH
DALBY REMOVAL HOMES

SCALE 1:100 @A3 SHEET 1 OF 1
DATE 18.11.2007 JOB No.
DRAWN L.BAIRD **D407-07**

A.G. MARTIN
DESIGN & DRAFTING

LICENSED BUILDING DESIGNERS
A.G.Martin Pty. Ltd. Lic. No. 1077723
Licensed Under QBSA Act 1991.

42 North Street Dalby, 4405
Telephone (07) 4662 1403
Facsimile (07) 4669 8049

